

Hisense

Hi-Smart Life

WiFi user manual

Dear users, this manual is used as the guidance for using mobile phones to connect with and control intelligent household appliances. For correct operation of the product, please read the manual carefully before using, and keep the manual safely and properly after reading.

Dear Hisense users, thanks for purchasing Hisense WiFi intelligent module, and thanks for your trust in us! We will provide sincere services to create a comfortable and healthy life space for you. Your valuable comments are highly appreciated by us. Note: Please understand that no further notice will be issued if the manual content is modified!



Stick the two-dimension code here.

Composition of intelligent household appliances

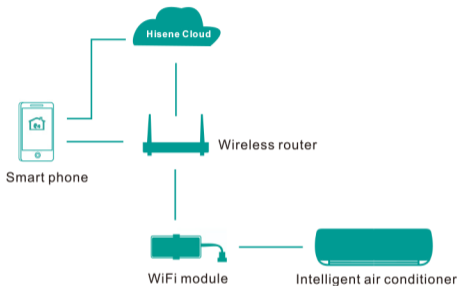

WiFi module is a vital composing part of intelligent household appliances, which could make connections between smart phones and other household appliances via WiFi technology. Users install Hi-Smart Life application on the phone, and send control command to WiFi module through this application. WiFi module transmits this command to household appliances, and then the household appliances feed back the execution results to the smart phone along the same path after finishing executing the command, thus achieving control and management for the household appliances.

Technical parameters of WiFi module

Product model	AEH-W4A1	Transmitting frequency	2.4GHz
Power supply	5V / 0.5A	Transmitting power	≤20dBm
Working temperature	0°C~40°C	Working humidity	20%RH~85%RH

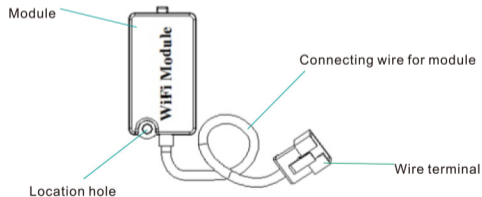

Schematic Diagram for WiFi Module

How to install WiFi module I

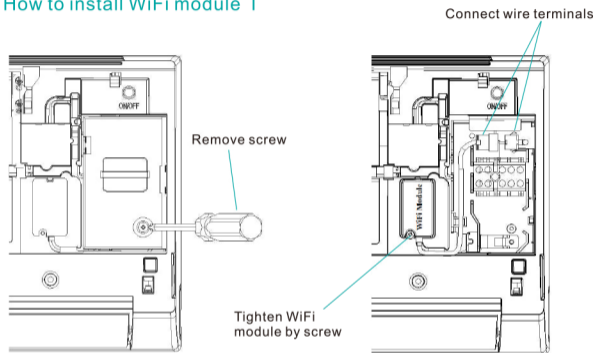

1. Open air conditioner panel, and use tools to dismantle the terminal cover;

2. Fix WiFi module with tools, and connect the wire terminals of the module and of the internal machine controller;

How to install WiFi module II

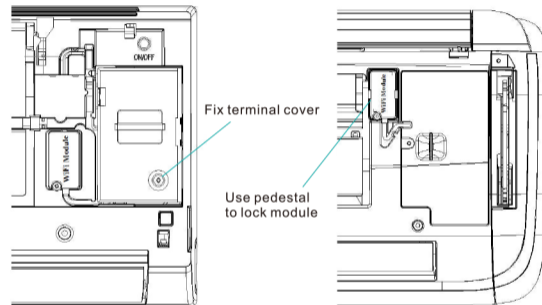

3. Fix the terminal cover with tools, and then WiFi module installation is finished.

The WiFi module shown in above figure shall not be tightened by screw, but be locked by pedestal, and then connect the wire terminals.

* Please refer to actual product for specific installation method. This manual is only served as reference.

Before using intelligent household appliances, users shall install the Application on the smart phone, register an account and connect with household appliances, thus achieving control of household appliances. This manual will guide users to download and install the Application (onto Android and IOS platform) and to bind and control household appliances. This APP only supports smart phones, and no tablet PC or other mobile devices are applicable.

Requirements for smart phone configuration

Terminal device	Android	IOS
System requirement	Android4.0 or higher version	IOS7.0 or higher version
Resolution ratio	800×480 or higher resolution ratio	960×640 or higher resolution ratio

Matters needing attention when using APP

Following conditions shall be met before using the WiFi function of Hisense intelligent household appliances:

- ▶ Smart phone installed with Hi-Smart Life application
- ▶ A 2.4GHz wireless router which connects to internet

- ▶ Make sure that no metal objects are around WiFi module and intelligent household appliances, which may interfere household appliance communication.
- ▶ Smart phone shall be operated under WiFi, not 3G/4G network, for binding and control of household appliances the first time.
- ▶ When using Hi-Smart Life Application under 3G/4G network, communication flow will occur.
- ▶ Please adopt authorized ISO system when using iphone.

Matters needing attention when using APP

1.How to download APP (phones shall be connected to internet)

Users can download the Hi-Smart Life Application by searching it in PLAY Store or APP Store, or by scanning the two-dimension code below directly. After download, please install the APP according to the instructions.



2.Process of registration and log-in (phones shall be connected to internet)

After installation, click the Application icon to enter.

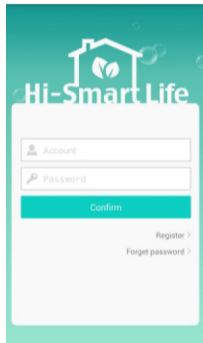

1. Users shall apply for an account before using the APP, and use this account to connect with household appliance. Click "Register" button to apply for the account.

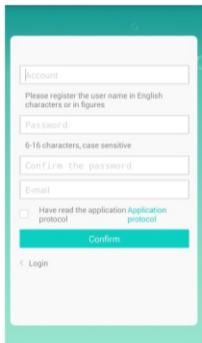

2. Fill in information, and click "Confirm" button to finish registration.

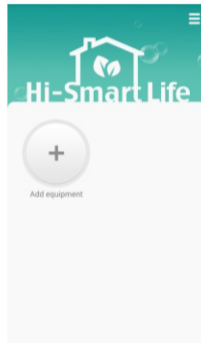

3. Log in the account to enter "Add equipment" interface

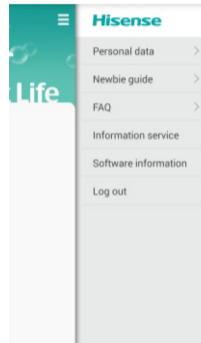

4. Click the symbol at top right corner to expand help interface, where users can choose related services. The "Information service" shown in above picture means that when household appliances malfunction, APP can supply information pushing service.

3. Household appliance configuration process with Android-system phones (phones shall be connected to internet via WiFi)

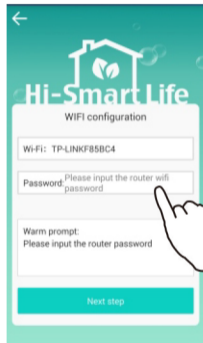

1. Click "Add Equipment" button to bind household appliances. "Wi-Fi: TP-LINKF85BC4" shown in above picture is the wireless router the phone connected to. Users need to type in router password for binding.



2. The household appliances which can be bound and their types will be shown on the interface. Users can choose the appliance to start binding.



3. Scan the model barcode of the appliance, which can be found on the outer surface of the appliance or in the operating manual.

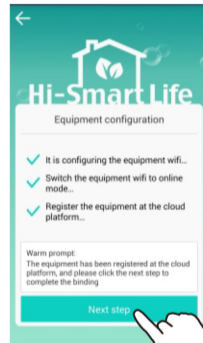

4. After finished these three procedures mentioned above, click "Next step".

4. Household appliance configuration process with IOS-system phones (phones shall be connected to internet via WiFi)

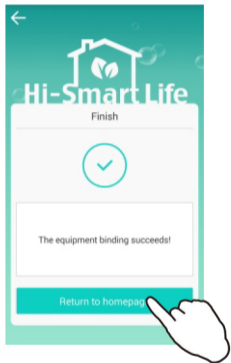

5. After "The equipment binding succeeds!" was shown on the interface, click "Return to homepage" to finish binding.

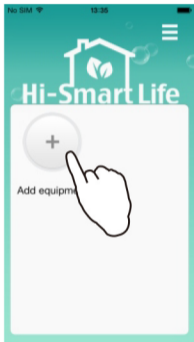

1. Click "Add equipment" button.

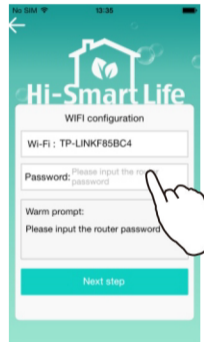

2. "Wi-Fi" shown in above picture is the wireless router the phone connected to. Users need to type in router password for binding. Then click "Next step".

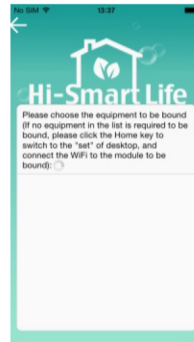

3. This interface is for appliance searching. If there is no appliance shown in the interface within 10s, click "Home" button, and switch to "settings" interface in IOS system;

Household appliance configuration process with IOS-system phones

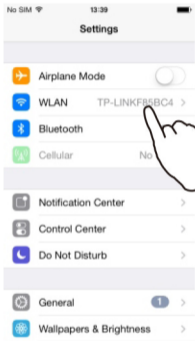

4. Click "WLAN";

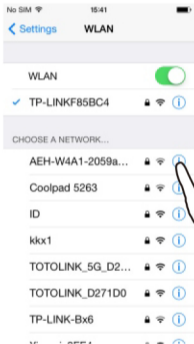

5. Select "AEH-W4A1-XXXX". If full name of the module is not clear, click exclamation mark to check it. This number shall be the same as the number of WiFi module shown in this manual;



6. Type in module password "12345678";

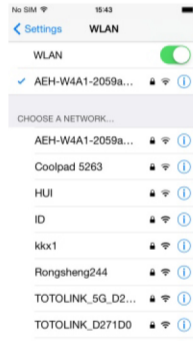

7. Connect the module;

Household appliance configuration process with IOS-system phones



8. Double click "Home" button and switch back to APP;



9. Select the appliance needed to be bound, and proceed with operations as APP required;

5. Household appliance unbinding (phones shall be connected to internet)

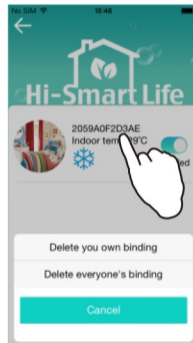

1. In the household appliance list, press the appliance needed to be unbound for about 3 seconds and above options will be shown. "Delete everyone's binding" unbinds all accounts connected to this appliance;

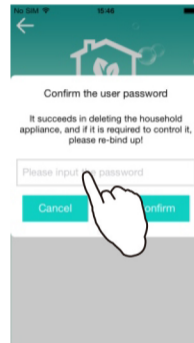

2. Type in log-in password, then the unbinding is done.

FAQ:**8. Smart phone has been connected to household appliance correctly, but no operation can be achieved?**

Restart APP or reconnect the smart phone to WiFi.

9. How to accomplish household appliance reconfiguration compulsorily?

When abnormality occurs to the binding, users can reconfigure appliance compulsorily as follows: after turning on air conditioner for 5 seconds, press the "Swing" key on the remote control continuously for six times, and reconfigure the appliance after air conditioner ringing five times.

10. How to unbind household appliance?

Press the appliance needed to be unbound in the appliance list interface for about 2-3 seconds, and then can choose "Delete your own binding" or "Delete all bindings".

11. Why does it fail to enter control interface for bound appliance?

- Make sure mobile phone can connect to internet;
- The control interface cannot be entered when appliance is offline. Please check whether the appliance is powered on;
- Switch off the appliance for 10 seconds, and then power on again;
- When internet connection is ok, reduce equipment quantities connected to the router;
- Check whether name and password for router have been changed or not. If it is changed, rebind the appliance.

12. How to change name and picture for the appliances?

In the main interface of household appliance control, click the picture shown at top left corner, then buttons for changing name and picture for the appliance will be shown. Users can change it accordingly.

13. How to connect one appliance with more than one account?

The appliance supports connecting to multiple terminals, and the last command shall prevail.

14. Household appliance configuration by using smart phone with IOS system is not successful?

Make the binding through ISO-system phone according to user manual. If the binding is not successful, please power off the appliance, and then reconfigure after switching the appliance on for 5 seconds.

15. After mobile phone system upgrade, APP or certain functions cannot be used?

After upgrading the phone operation system, if the APP cannot be used, please upgrade APP to the latest version by following ways: enter APP main interface, click menu bar at the top right corner, choose "Software information", and check whether there is latest version.

16. Descriptions of household appliance unbinding

When mobile phone WiFi and household appliance are connected to the same router, users are able to relieve bindings for all accounts and the binding of his own account as well; while mobile phone and the appliance are not connected to the same router or mobile phone is using 3G/4G network, users can only unbind his own account. "Delete your own binding" only cancels the connection between your own account and the appliance, while "Delete all bindings" cancels the connections between all accounts and the appliance.

17. How to use APP when there is no network available?

When there is no network available, connect mobile phone WiFi to the hotspot of AEH-W4A1, and enter APP directly.

Product list:

- WiFi module: 1
- User manual: 1
- Spare bar code: some

*All technical information specified in this manual shall be subject to actual performance, and the final explanation right should be reserved by Hisense.

6.Change name and picture for household appliances

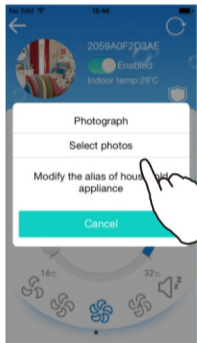

Users can define names and pictures for household appliances themselves. Press the picture at top left corner for about three seconds, and the above change buttons will appear, by which users can change name and picture of the appliance.

⚠ Matters needing attention for wireless router

- It is recommended to use the wireless router equipped with below mentioned chip:

Chip model	Chip supplier
QCA9558-AT4A	Qualcomm
TP9343-AL3A	Qualcomm
QCA9533-AL3A	Qualcomm
AR9341-AL1A	Qualcomm
AR9341-PL3A	Qualcomm
TP9343-AL3A	Qualcomm
BCM5357C0KFBG	Broadcom
BCM4323	Broadcom
BCM4706KPBG	Broadcom
RTL8196C	Realtek

- Router's SSID and PASSWORD are set in English and numbers without supporting other languages, and less than 31 characters are required for both.
- Router shall support detection, broadcast and host functions of UDP, and shall be able to open the ports of 6819/5820/5821/7820/7821/8080 to external network.
- Uncertified router may not be able to connect with an air conditioner.Certified router has the logo of belowon the package or user manual.



FAQ:

1.How to download APP?

Connect the phone to internet, and download the Hi-Smart Life APP by searching it in PLAY Store and APP Store for Android users and IOS users respectively, or by scanning the two-dimension code in this manual.

2.How to register?

Enter Hi-Smart life log-in interface, click "Register" button, enter next interface, type in account name, password and email address, and then click user agreement to finish registration.

3.How to modify password?

After logging into the account successfully, click the "Menu" button at top right corner in the interface. User password can be modified in "Personal data".

4.Forget password?

In user log-in interface, click "Forget password", then type in account name and registered email. Click "Confirm" button, then the new password will be sent to user's phone, with which users can use to log in the account, and then modify the password.

5.How to log out account?

After logging in the account successfully, click the "Menu" button at top right corner in the interface, and then click "Log out".

6.How to make household appliance configuration (household appliance binding)?

Please refer to user manual for detailed operation procedures.

7.During household appliance configuration, no appliance is found on the APP search interface?

- Make sure the wireless router can connect to external network;
- Make sure the appliance is powered on;
- Make sure mobile phone and the appliance are connected to the same router.